

CHARTER TOWNSHIP OF MARQUETTE MICHIGAN NATURAL RESOURCES TRUST FUND ACQUISITION PROJECT LOCATION MAP

Part of NW 1/4 of NE 1/4 and Part of NE 1/4 of NW 1/4, Section 20, T48N - R25W,
Marquette County, Michigan

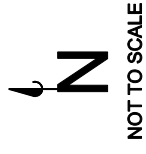
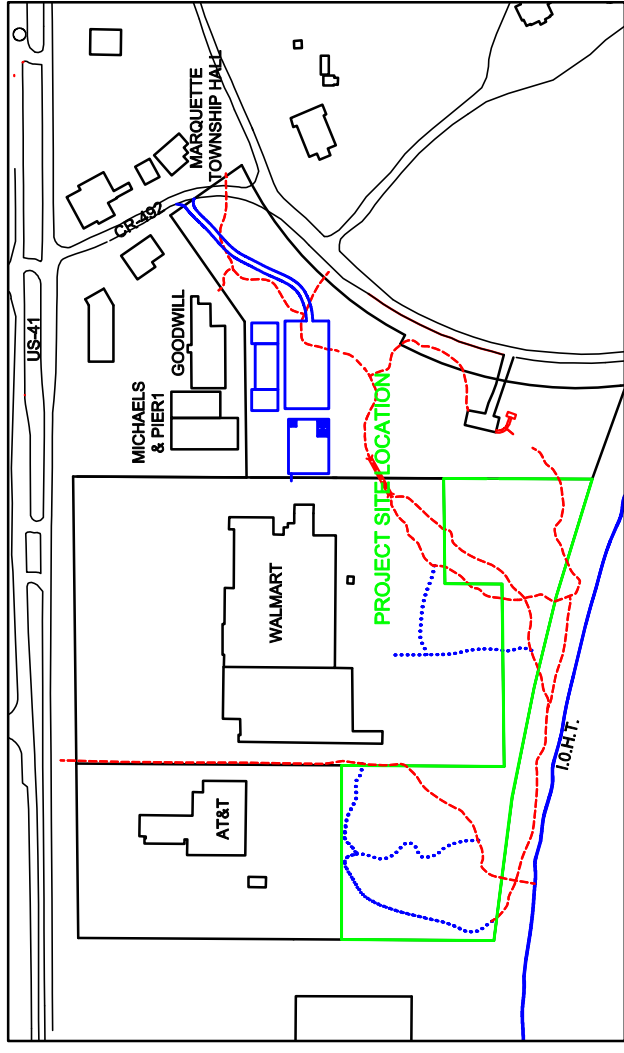
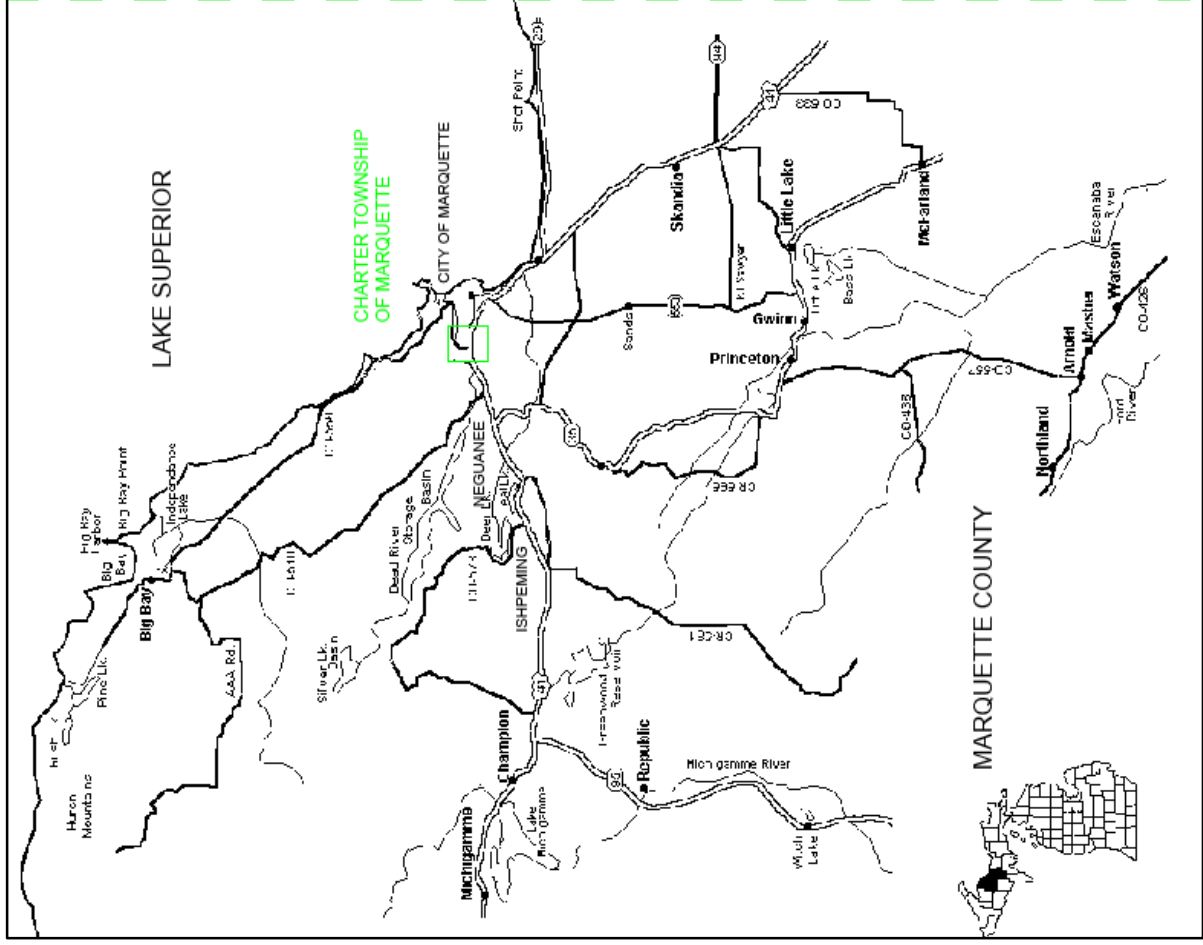

ENGINEERS **PLANNERS** **LAND SURVEYORS**

ECL
ECL of Escanaba Building Mercos 424 South Pine Street 49849 Escanaba, Michigan
"Quality Service to the SLP Since 1974" (906) 485 1011

Prepared For:
Charter Township of Marquette
161 County Road 492
Marquette, MI 49855

Drawn By: BLK
 App'd By: SH
 Date: 01.11.10
 Job No: 01018 Loc
 Sheet: 01 OF 01